



**Einbauanleitung Elektrosatz  
Anhängervorrichtung mit 13-P Steckdose  
lt. DIN/ISO Norm 11446**

**Instructions de montage du faisceau  
électrique pour crochet d'attelage  
conforme à la norme  
DIN/ISO 11446 prise 13-P**

**Fitting instructions electric wiringkit  
towbar with 13-P socket up to  
DIN/ISO norm 11446**

**Montage-handleiding elektrokabelset voor  
trekhaak met 13-P contactdoos  
vlg. DIN/ISO norm 11446**

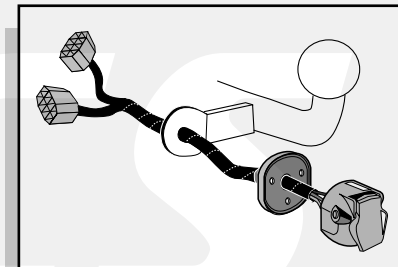

NISSAN X-TRAIL 2001-

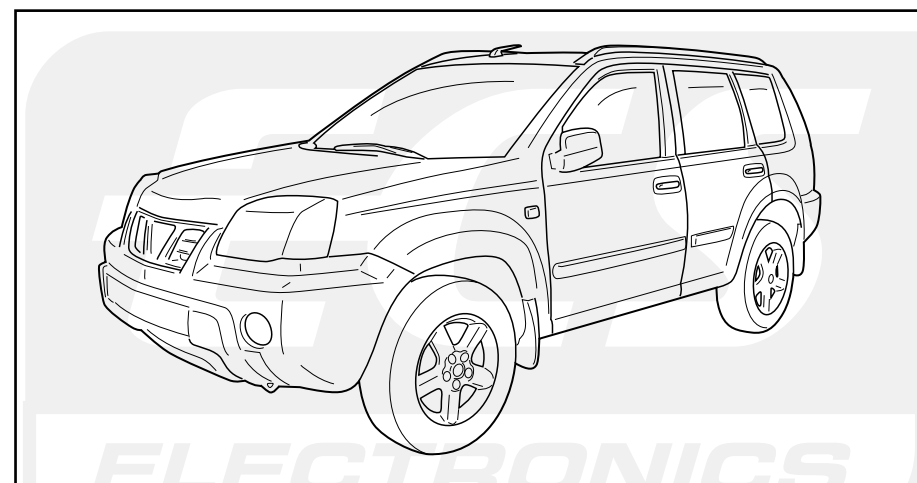

Bestel Nr.: NI-019-DB

\* Teilliste

\* Liste de pieces

\* Part list

\* Onderdelenlijst

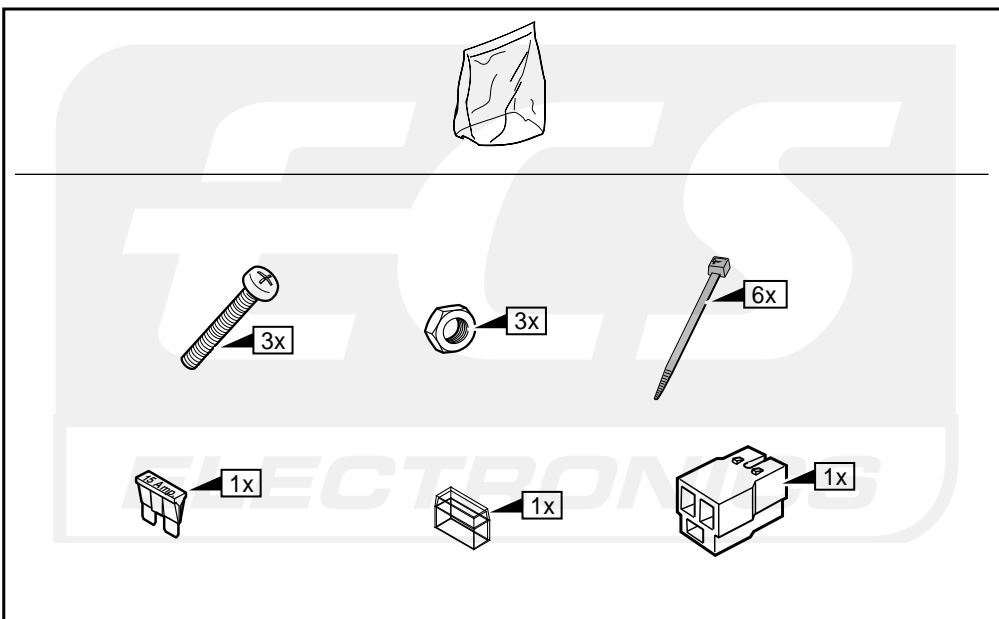
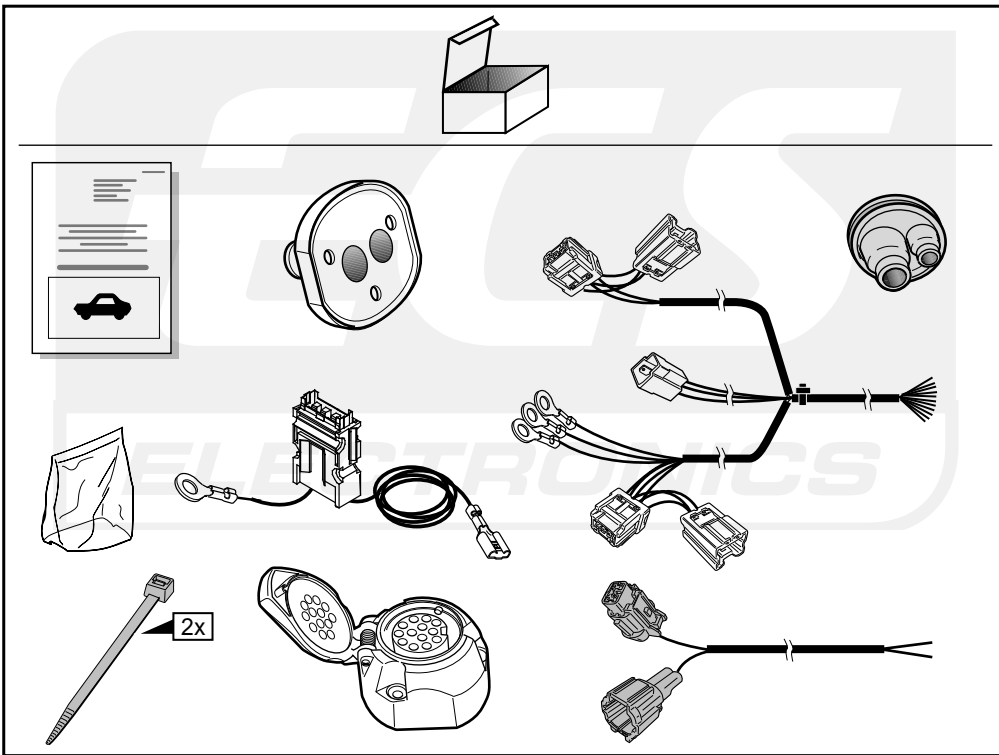

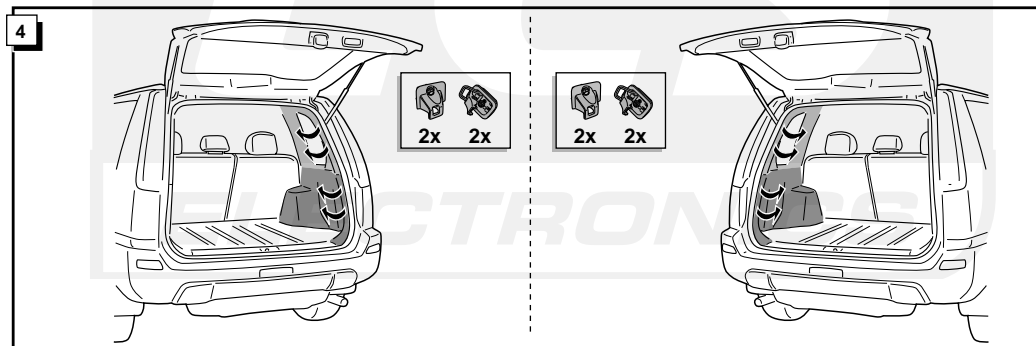
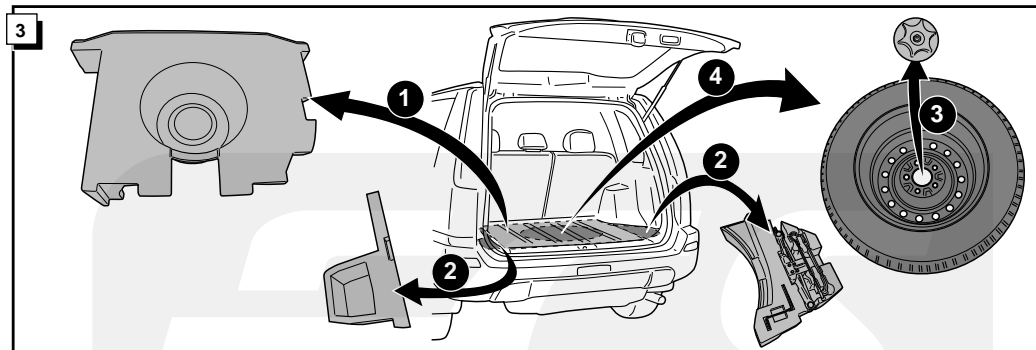
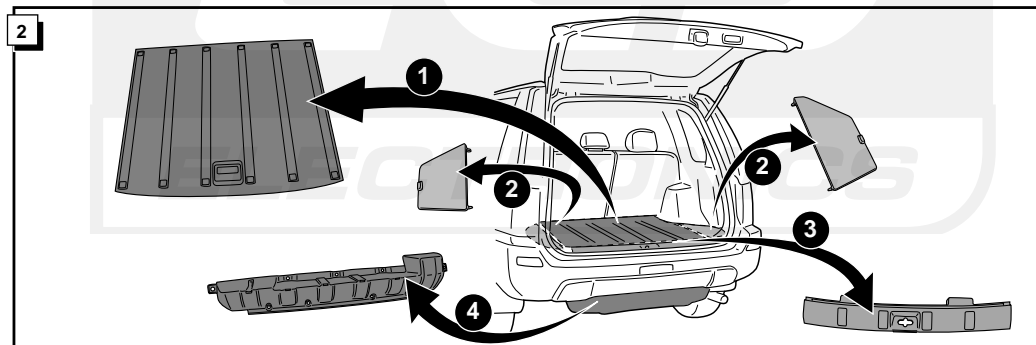
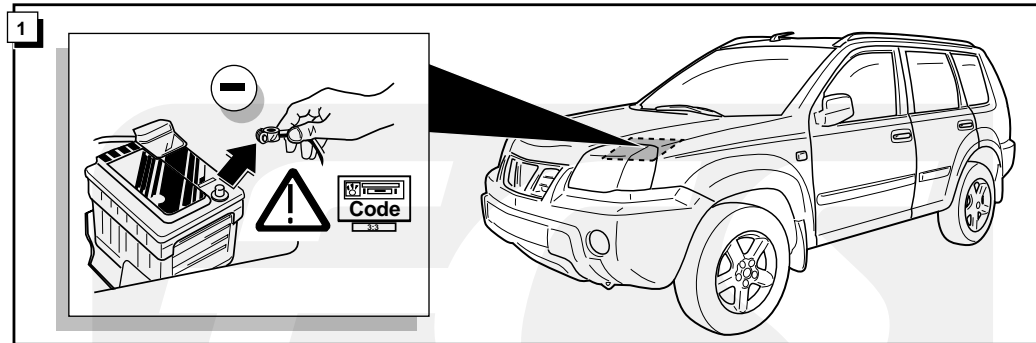

INFO

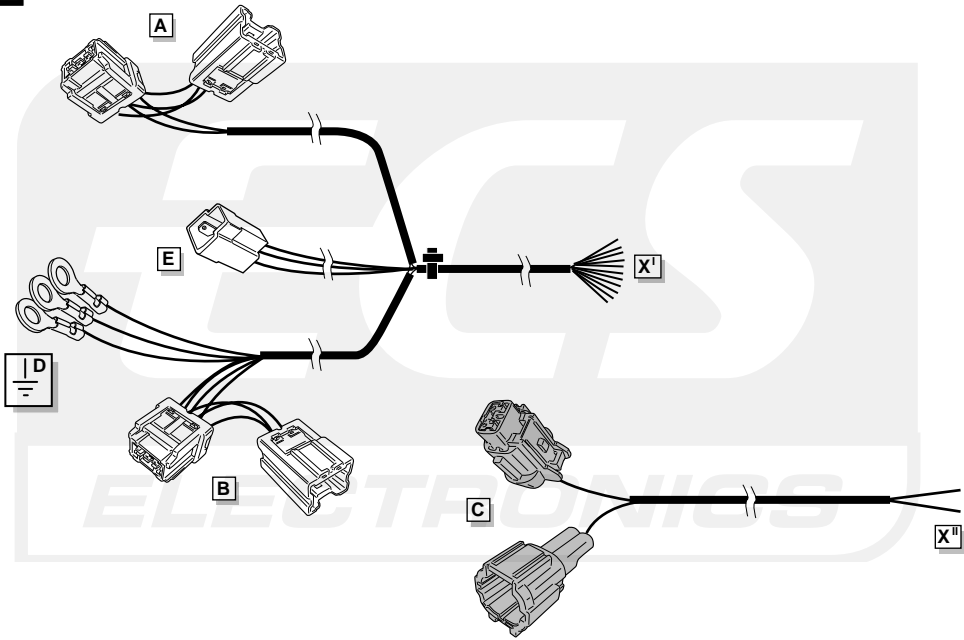

ROUTING

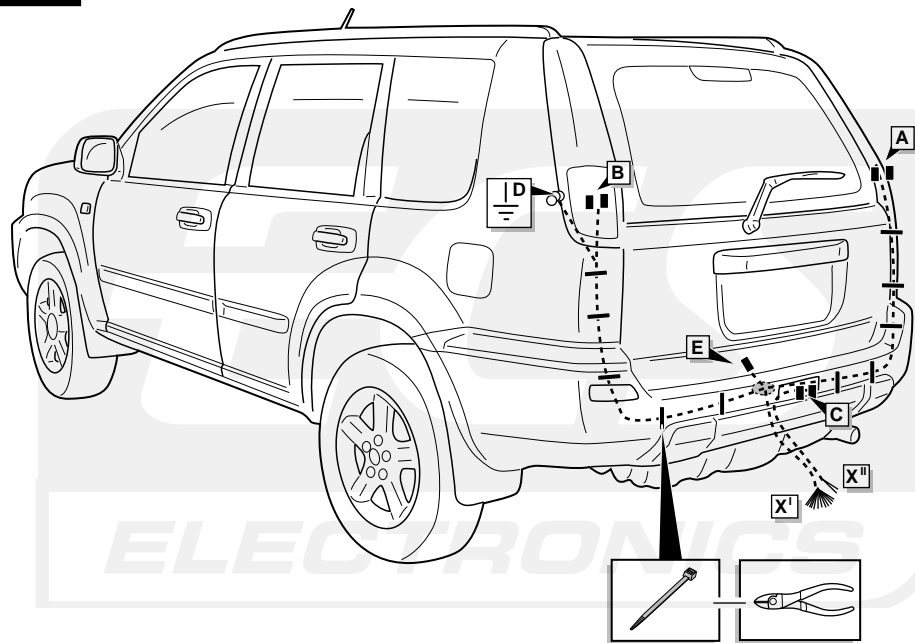

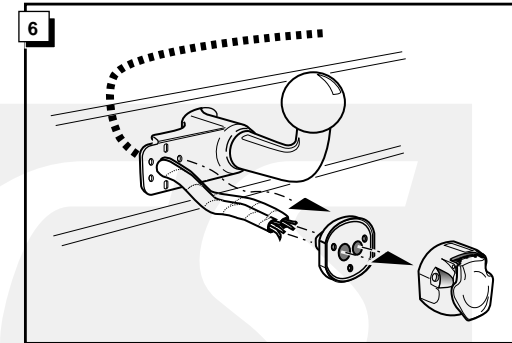
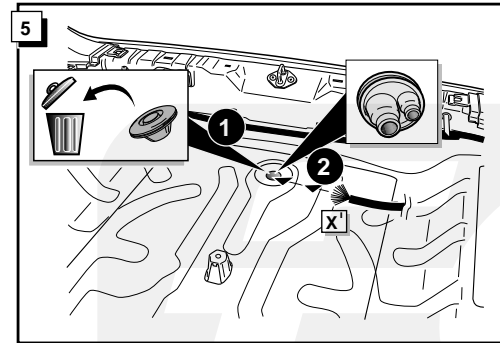
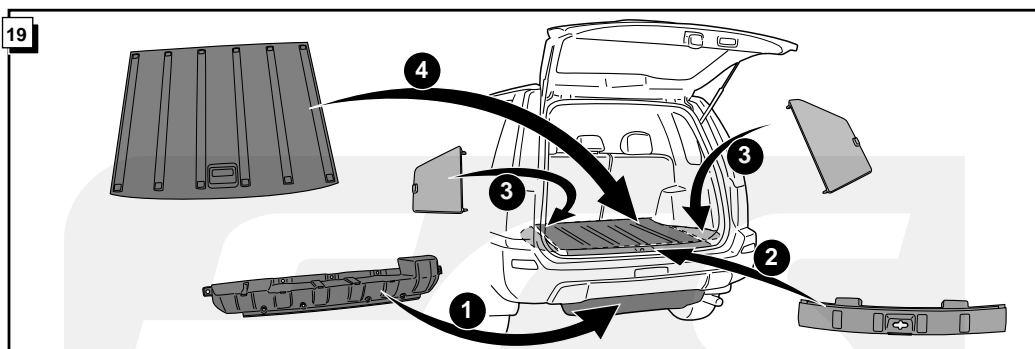
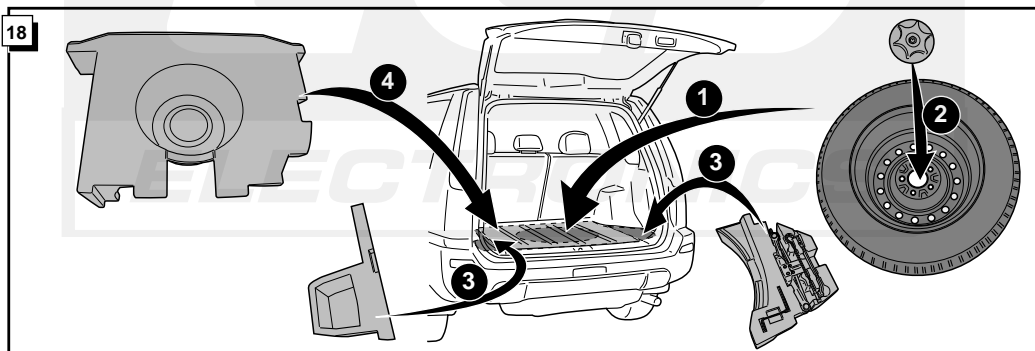
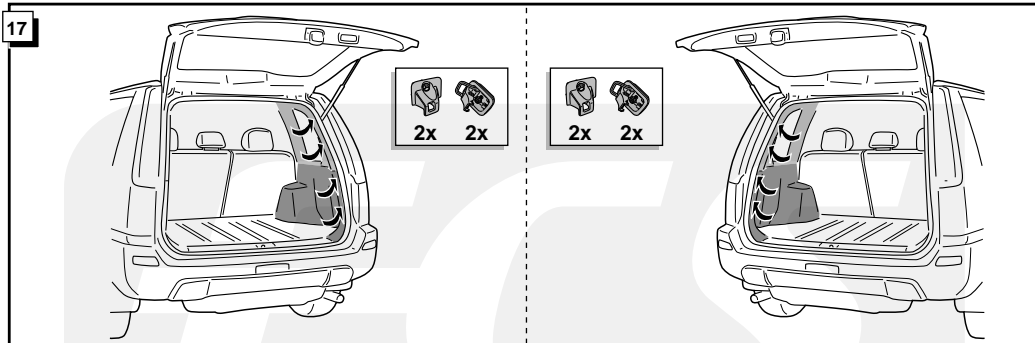

**INFO** Anschluß Steckdose / Connection de la prise / Socket connection / Contactdoos aansluiting

DIN/ISO 11446	(D)	(F)	(GB)	(NL)
	1/L gelb	jaune	yellow	geel
	2 blau	bleu	blue	blauw
	2a grau	gris	grey	grijs
	3/31 weiß	blanc	white	wit
	4/R grün	vert	green	groen
	5/58-R braun	marron	brown	bruin
	6/54 rot	rouge	red	rood
	7/58-L schwarz	noir	black	zwart
	8 schwarz/rot	noir/rouge	black/red	zwart/rood
	9 braun/weiß	marron/blanc	brown/white	bruin/wit
	10 rot	rouge	red	rood
	11 weiß	blanc	white	wit
	12 rot/blau	rouge/bleu	red/blue	rood/blauw
	13 weiß	blanc	white	wit

